



## SHARK EYE REPLACEMENT, SAFETY STEP

READ THESE INSTRUCTIONS COMPLETELY BEFORE YOU START. IF YOU DON'T UNDERSTAND THESE INSTRUCTIONS, PLEASE CALL 800-453-1192 FOR ASSISTANCE

1. Failure to comply with all instructions may result in serious injury.
2. Make sure this kit is compatible with your ladder. Before installing this kit, identify all kit components. If any components are missing, damaged or if you have any questions concerning the use of this kit on Little Giant Ladder Systems® products, please contact our Customer Experience Team at 800-453-1192. Do not substitute any components.
3. Inspect the ladder before installing this kit. Repair or replace any damaged or missing parts before using the ladder. Use only Little Giant Ladder Systems® replacement parts. If you are unable to repair it, discard the ladder.

### COMPONENTS INCLUDED



### TOOLS REQUIRED



HAMMER



FLAT HEAD SCREWDRIVER

NOTE: IF ANY OTHER PART OF THE LADDER IS DAMAGED BEFORE OR DURING THE PROCESS OF INSTALLING AND/OR REPAIRING, Please contact our customer experience team for assistance at 800-453-1192.  
DO NOT USE A DAMAGED LADDER!

## BREAKDOWN

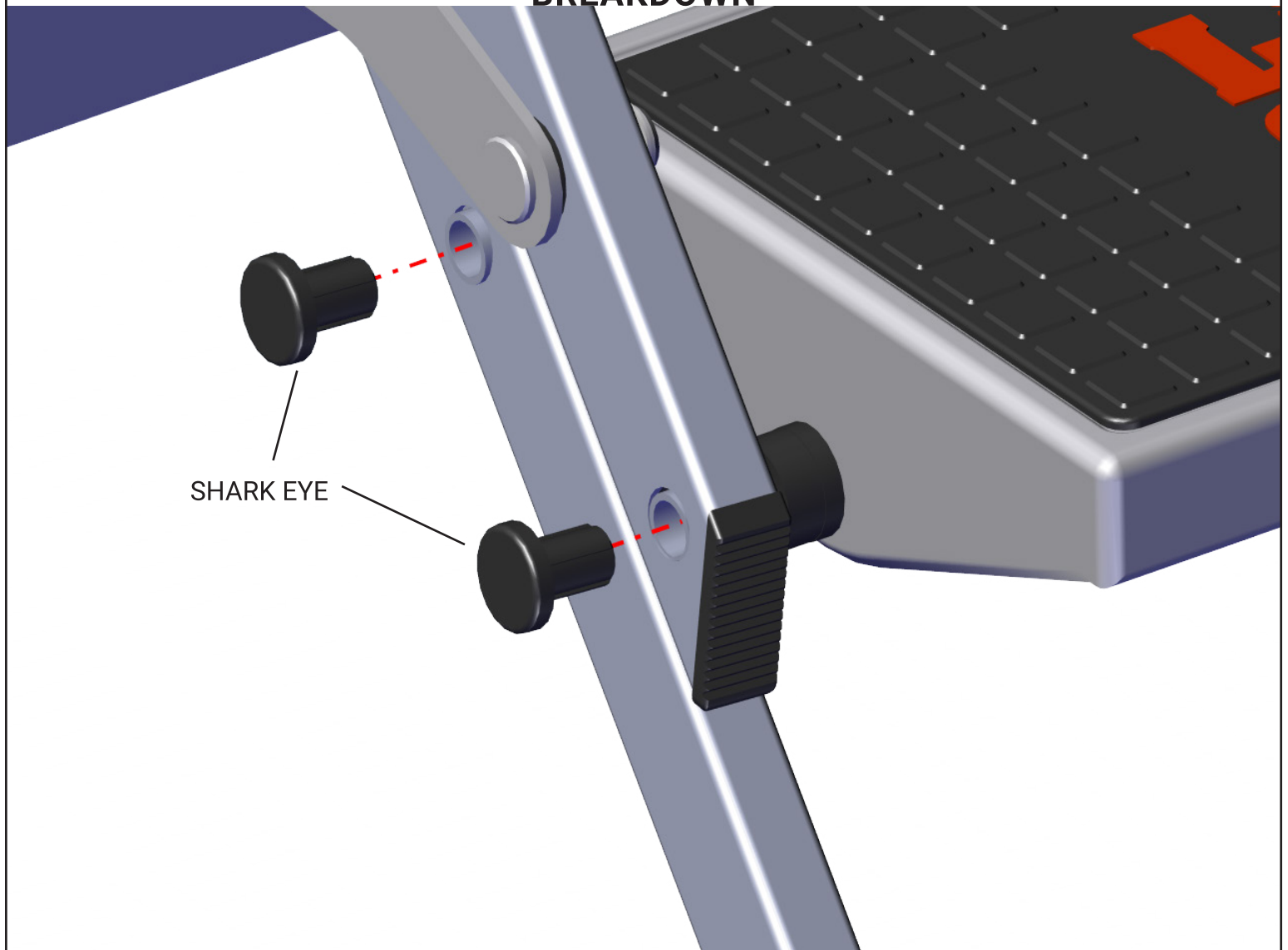

1. Steps 2-8 can be duplicated for all of the Shark Eye's on the Safety Step.

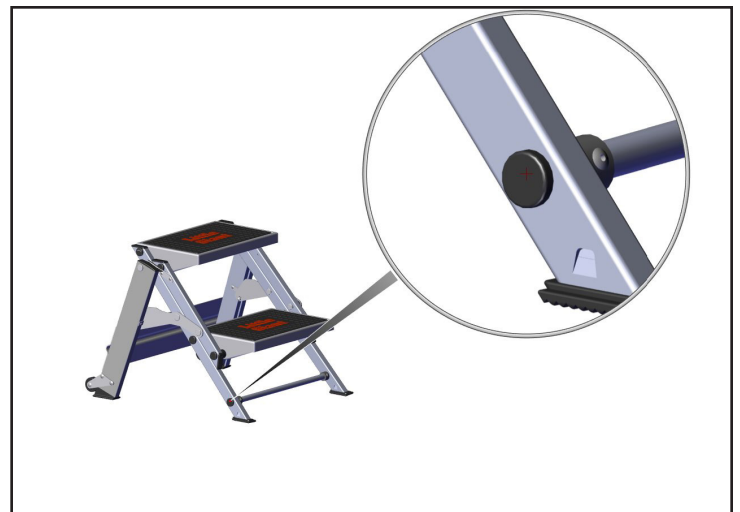

2. Locate the Shark Eye that needs to be replaced.

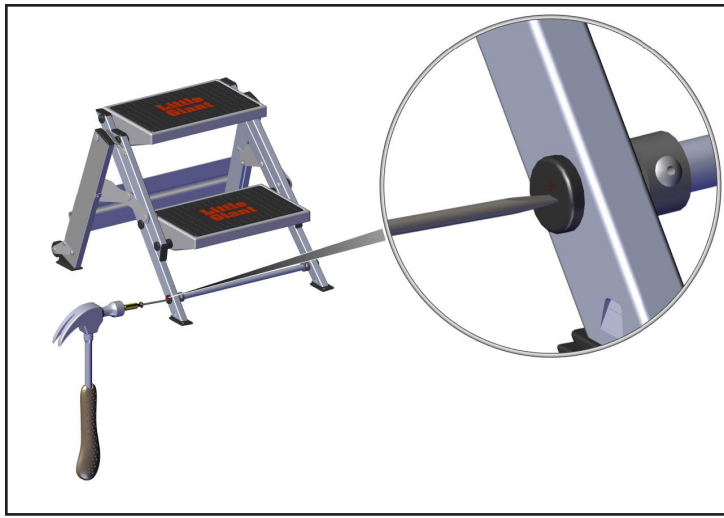

3. Take a hammer and a flat head screwdriver, place in the center of the Shark Eye, then tap butt of screwdriver with the hammer until the head of the screwdriver breaks through the face of the Shark Eye.

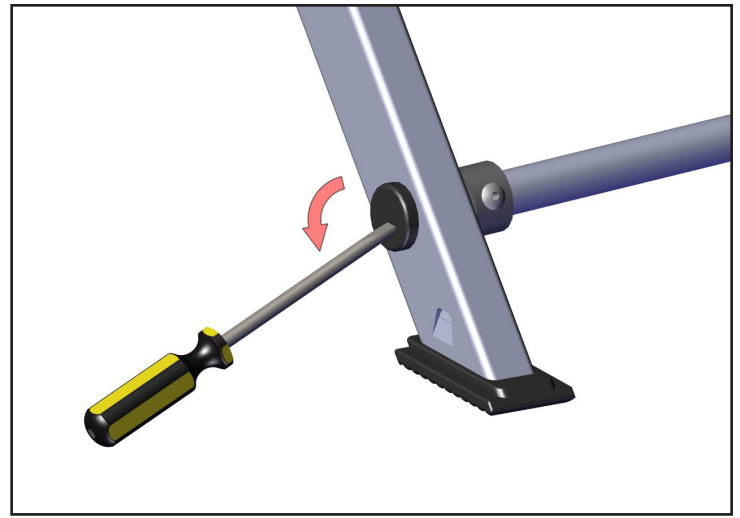

4. Apply leverage with the screwdriver.

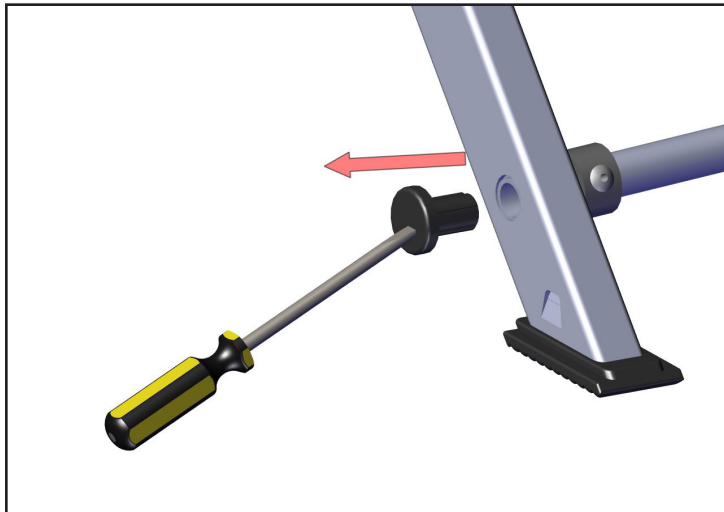

5. Use the leverage from step 4 to pull outwards, releasing the Shark Eye.



6. If steps 3-5 aren't effective, use pliers to loosen the Shark Eye.

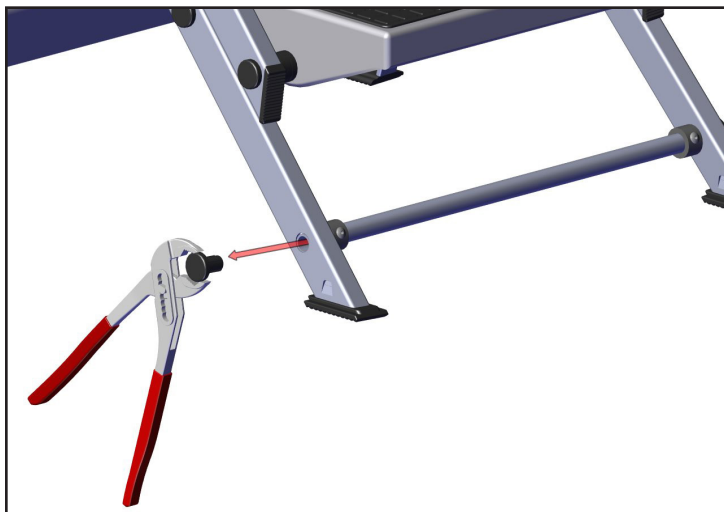

7. Once Shark Eye is loose, pull free from ladder.

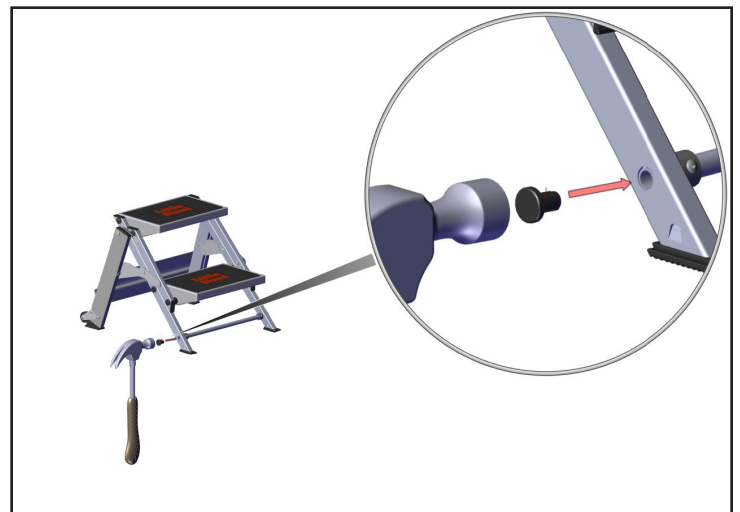

8. With the new Shark Eye (included in kit) and hammer, tap until fully seated.



9. When completed, stand the ladder upright and make sure the ladder is stable before use.